

1541
Front View
1575

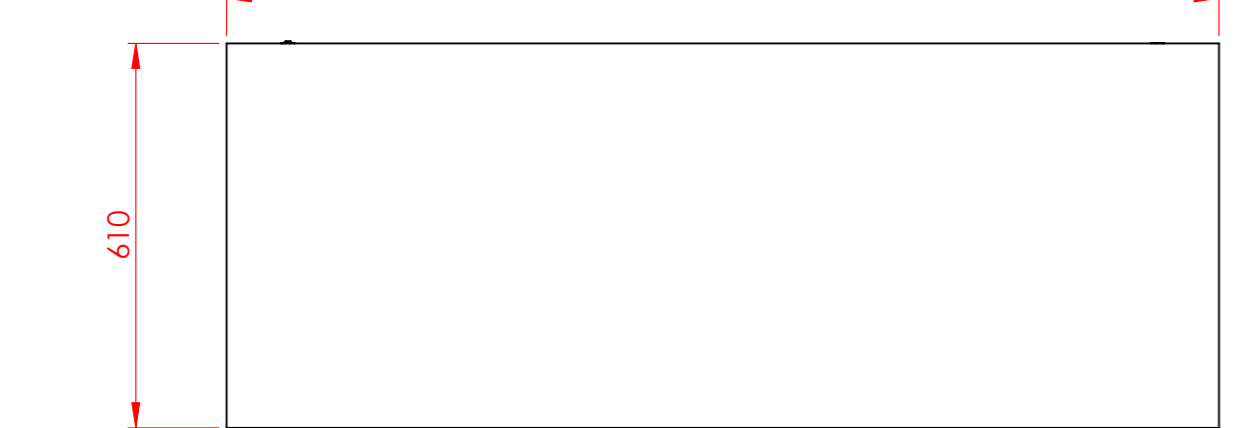

Top View

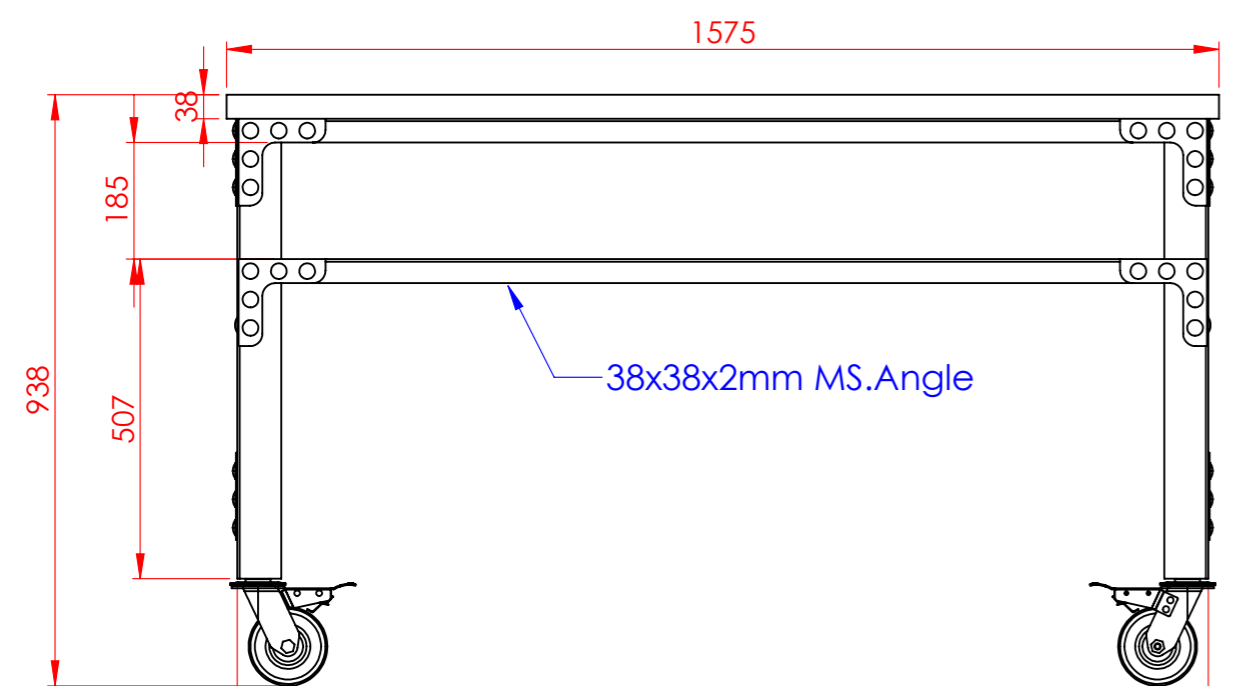

1541
Back View

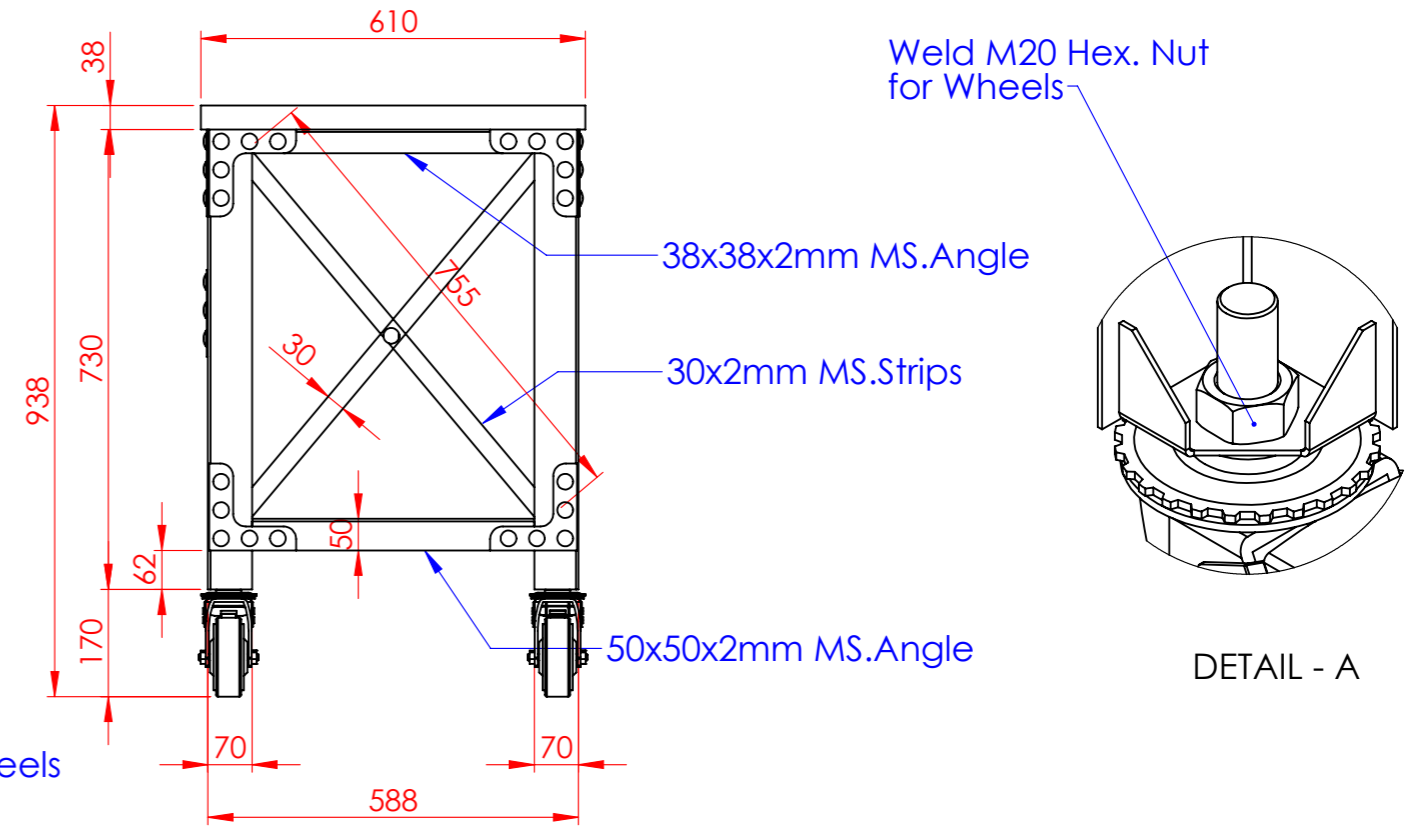

Side View

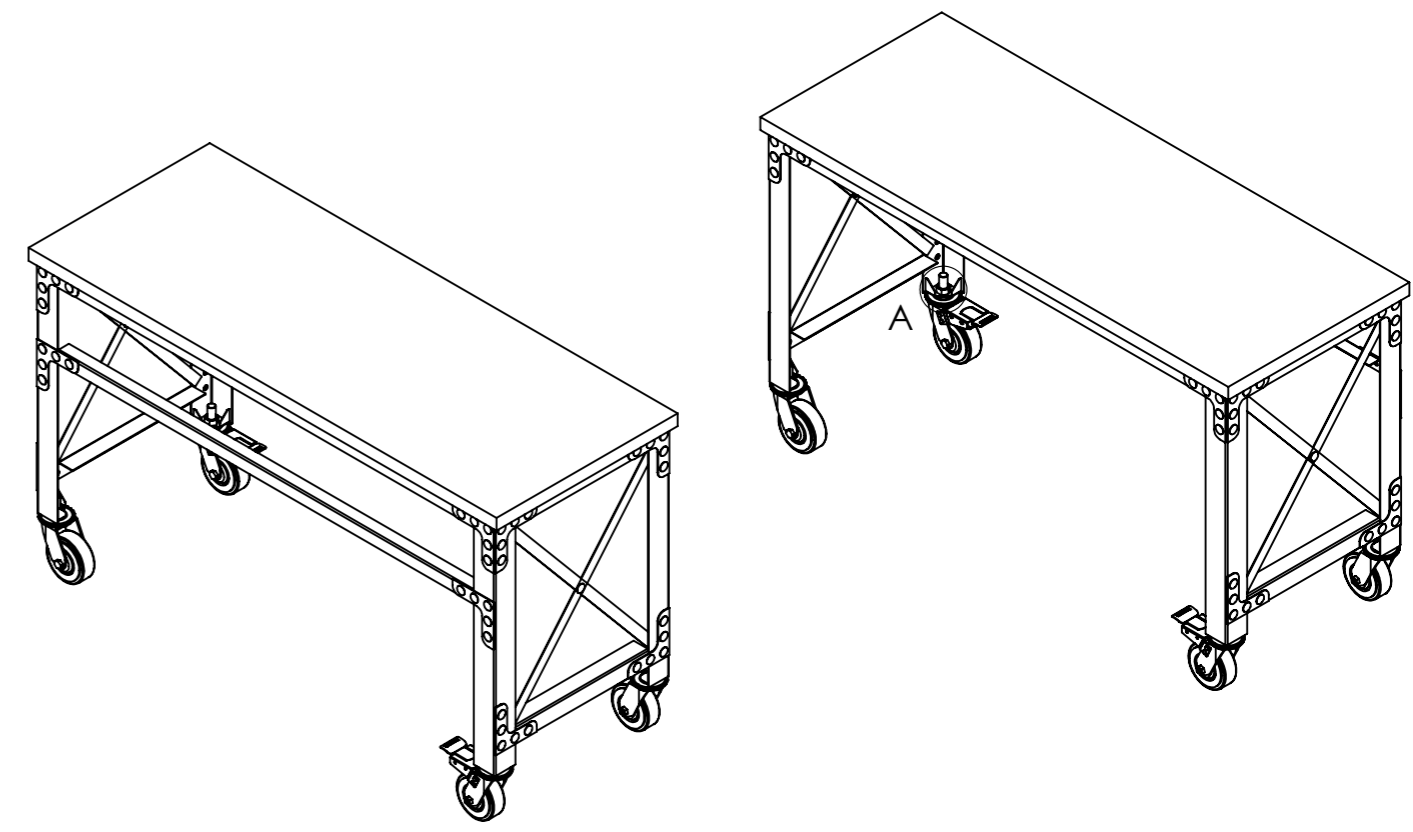
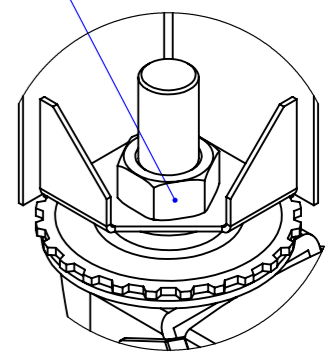

DRAWN	Tahir	SHEET THK.:	-NA-	WEIGHT:	-----	S. AREA:	4972495.83mm ²
CHECKED	Harout k	MAT.:	Acacia Wood / Metal	FINISH:	Powder coated		
APPROVED	Harout k	TITLE: 62" Industrial Metal & Wood Work TABLE					
DATE	25/11/2019						
DWG. NO.	NWB62 000	PRODUCT:	Work Table 62"	MODEL:	1575x610x940mm		
General Tolerance : ± 0.1 mm		INTERMETAL		P.O. Box 474039, Jabel Ali, Dubai Investment Park - 1, Dubai (United Arab Emirates)		SHEET 1 OF 8	
COLOUR	Black	Design & Development Department		Tel: 04-8841650 Fax: 04-8841934		SCALE REV. N.T.S. 00	
QUANTITY		ALL DIMENSIONS ARE IN MILLIMETERS AND ALL BEND RADII TO BE MIN. R AT 90° BEND, UNLESS SPECIFIED OTHERWISE THIS DRAWING IS THE PROPERTY OF TSSC, NOT TO BE REPRODUCED AS A PART OR WHOLE WITHOUT PRIOR CONSENT OF TSSC					